

TF GF200

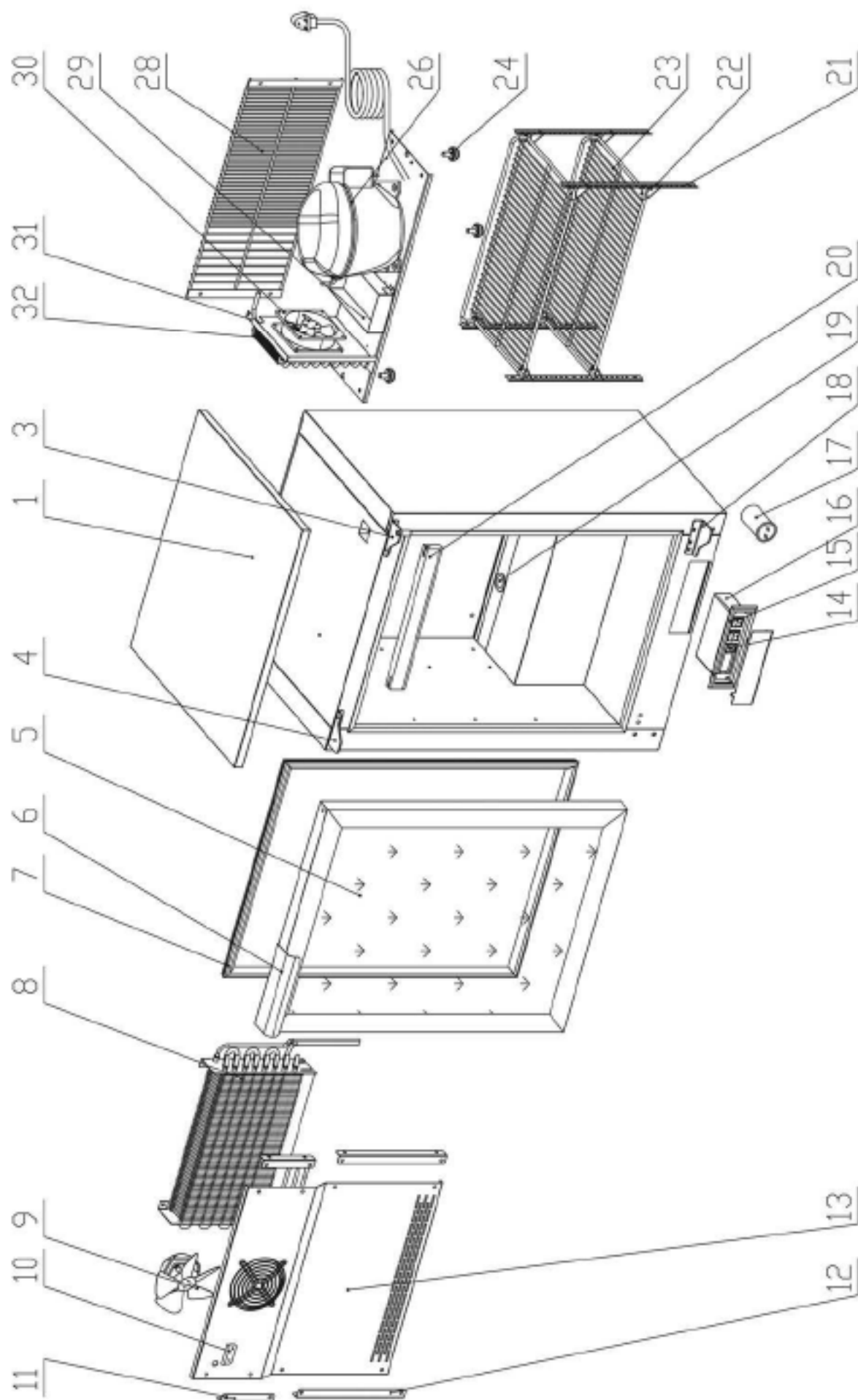

| Pos.No. | Part No | Description |
|----------------|----------------|-------------------------------|
| 00001 | 2125000001 | TOP |
| 00003 | 2125000003 | TOP HINGE RIGHT |
| 00004 | 2125000004 | TOP HINGE LEFT |
| 00005 | 2125000005 | GLASS DOOR |
| 00006 | 2125000006 | HANDLE |
| 00007 | 2125000007 | GASKET |
| 00008 | 2125000008 | EVAPORATOR |
| 00009 | 2125000009 | EVAPORATOR FAN |
| 00010 | 7200000529 | SENSOR FIXED CLIP |
| 00011 | 2125000011 | FAN COVER BRACKET |
| 00012 | 2125000012 | EVAPORATOR COVER BRACKET |
| 00013 | 2125000013 | EVAPORATOR COVER |
| 00014 | 7110000388 | THERMOSTAT XR06CX, 20 A, BLUE |
| 00015 | 7110002401 | MAIN SWITCH |
| 00016 | 2125000016 | THERMOSTAT BOX |
| 00017 | 2125000017 | CAPACITOR FOR DOOR HEATER |
| 00018 | 2125000018 | BOTTOM HINGE |
| 00019 | 7200000531 | DRAIN PIPE |
| 00020 | 2125000020 | LED LIGHT |
| 00021 | 2125000021 | RAIL FOR SHELVES |
| 00022 | 7190100010 | SHELF CLIP |
| 00023 | 2125000023 | WIRE SHELF |
| 00024 | 7200000900 | ADJUSTABLE FEET |
| 00026 | 7300010253 | COMPRESSOR EMT2125U R290 |
| 00028 | 2125000028 | COMPRESSOR GRILL |
| 00029 | 2125000029 | WATER PAN |
| 00030 | 2125000030 | CONDENSER FAN |
| 00031 | 2125000031 | CONDENSER FAN BRACKET |
| 00032 | 2125000032 | CONDENSER |