

RESERVDELAR

SC SD 217

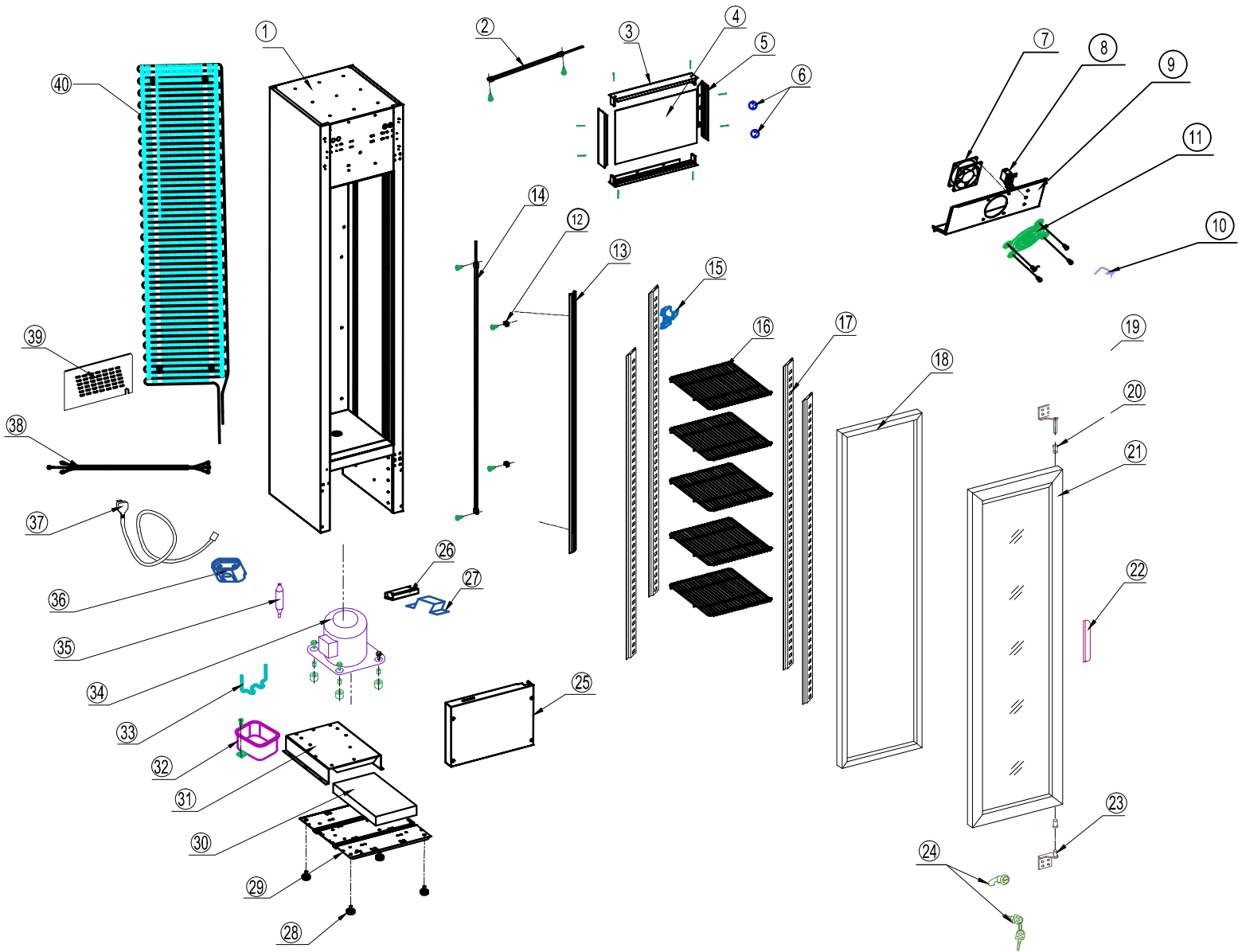

| Pos.No. | Part No | Description |
|----------------|----------------|---|
| 2 | RES-16885 | LED light canopy |
| 3 | RES-16886 | Rail for top light cover |
| 4 | RES-16887 | Top light cover |
| 5 | RES-16888 | Side cover for top light |
| 6 | RES-13407 | Light switch |
| 7 | RES-16382 | Evaporator fan motor |
| 8 | RES-13397 | Mechanical Thermostat |
| 9 | RES-16890 | Inner fan board |
| 10 | RES-14920 | Thermostat Konb |
| 11 | RES-14921 | Evaporator Fan cover |
| 12 | RES-16891 | Support for LED light |
| 13 | RES-16892 | Inner lamp Cover |
| 14 | RES-19616 | White LED inner light, new type |
| 15 | RES-19618 | K-Clip new version |
| 16 | RES-16894 | Shelf |
| 17 | RES-14928 | K-support |
| 18 | RES-16895 | Door Gasket |
| 19 | RES-14930 | Upper hinge(left-right) |
| 20 | RES-14931 | Door Axis Sleeve |
| 21 | RES-16896 | Glass Door SD216 |
| 22 | RES-16897 | Door Handle |
| 23 | RES-14934 | Lower hinge |
| 24 | RES-14935 | Lock |
| 25 | RES-16898 | Front grill |
| 26 | RES-16899 | Power supply for inner LED light |
| 27 | RES-16900 | Supporter for Power supply of inner LED |
| 28 | RES-16901 | Feet |
| 29 | RES-16902 | Compressor supporter |
| 30 | RES-16903 | Block set for compressor supporter |
| 31 | RES-16904 | Fix board for compressor |
| 32 | RES-16905 | Water Tray |
| 33 | RES-16906 | Venting tube |
| 34 | RES-16907 | Compressor |
| 35 | RES-16908 | Drier |
| 36 | RES-14949 | Power cord clip |
| 37 | RES-14950 | Power Cord |
| 38 | RES-14951 | Compressor wire |
| 39 | RES-16909 | Back cover |
| 40 | RES-16910 | Hang type of wire condenser |
| 100 | RES-23015 | Price tag |