

# RESERVDELAR

## SC KF 991

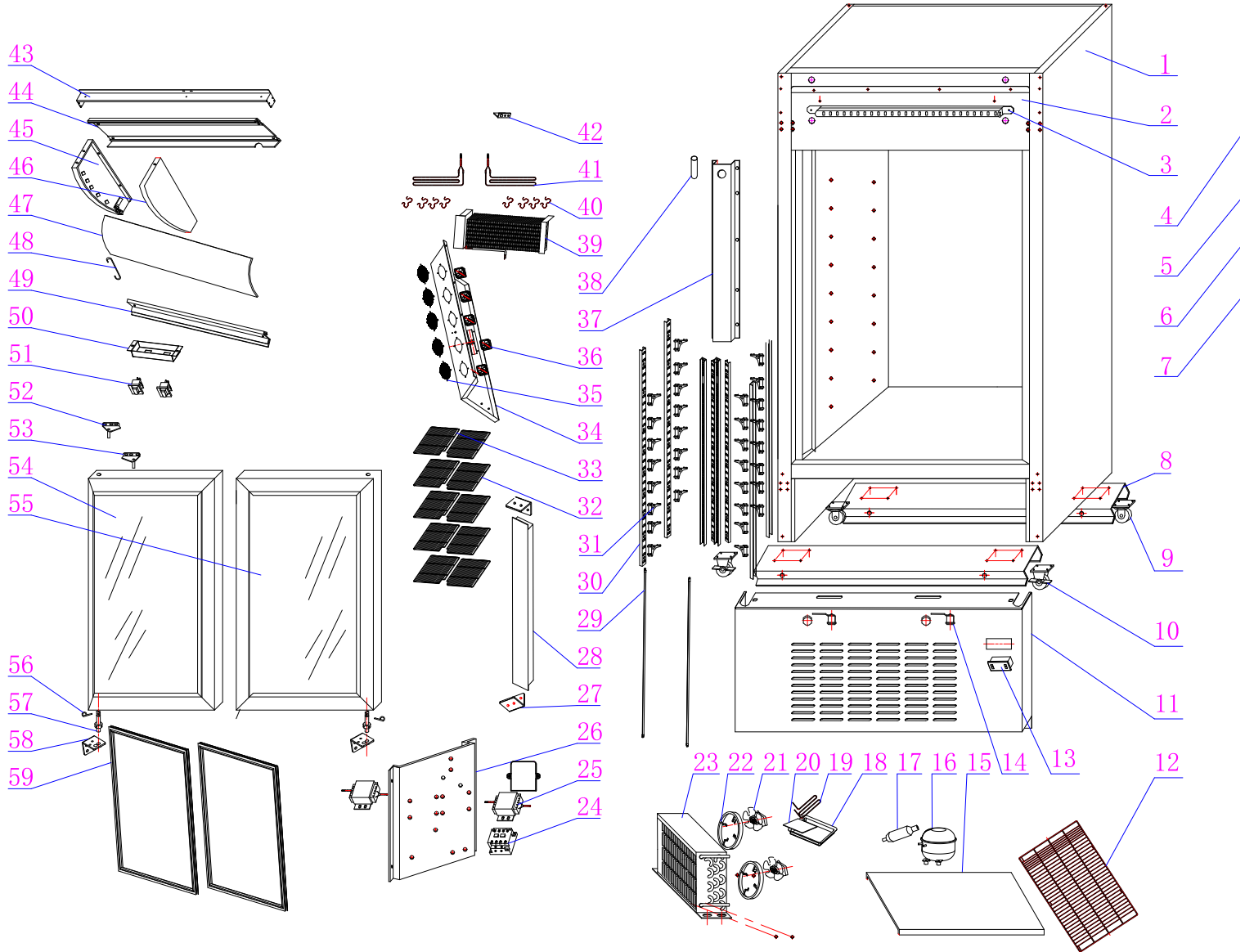

<b>Pos.No.</b>	<b>Part No</b>	<b>Description</b>
2	RES-22804	Light box base plate
3	RES-22805	Led Light canopy
4	RES-22806	Water elbow
5	RES-22807	Drain cover
6	RES-22808	PVC drain-pipe
7	RES-22809	Drain clamp
8	RES-16280	Castor fixed plate
9	RES-16281	Swivel wheel 2 pcs
10	RES-16282	Castor 2 pcs with brake
11	RES-16283	Kick plate
12	RES-16284	Compressor room cover
13	RES-22810	Controller
14	RES-16286	Lock
15	RES-16287	Compressor base plate
16	RES-22811	Compressor
17	RES-16289	Dryer filter
18	RES-16290	Drip tray
19	RES-16291	Heating tube
20	RES-16292	Drip tray clapboard
21	RES-16293	Condenser fan
22	RES-16294	Condenser fan case
23	RES-16295	Condenser
24	RES-16298	Relay
25	RES-16299	Transformer
26	RES-16301	Electrical mounting plate
27	RES-22812	Relay
28	RES-16303	Middle post fixed plate
29	RES-16304	Middle post
30	RES-22813	LED light in cabinet
31	RES-16307	Shelf ladder
32	RES-16308	Shelf clip set of 4 pcs
33	RES-16309	Shelf right
34	RES-16310	Shelf left
35	RES-22814	Evaporator facn installation plate
36	RES-13246	Evaporator fan case
37	RES-22815	Evaporator fan
38	RES-16312	Suction pipe cover
39	RES-16313	Drain-pipe
40	RES-16316	Evaporator
41	RES-16318	Heating tube clip
42	RES-16319	Heating tube
43	RES-22816	Evaporator baffle
44	RES-16321	mounting plate of defrosting probe
45	RES-16324	Light box stiffening plate
46	RES-16325	light box upper cover
47	RES-16326	Light box left side cover
48	RES-16327	Light box right side cover
49	RES-16328	Header panel
50	RES-16329	Clip of light box lower cover
51	RES-16330	Light box lower cover
52	RES-22817	Gate switch mounting panel
53	RES-16296	Fan switch
54	RES-16331	Left door top hinge
55	RES-16332	Right door top hinge
56	RES-22818	Glass door left
57	RES-22819	Glass door right
58	RES-16336	Pin
59	RES-16337	Bottom door axe
60	RES-16338	Bottom door hinge
61	RES-22820	Door gasket
62	RES-22821	Transformer